

SECTION A-A

PENDING VALIDATION - FINISH UNDERGOING DEVELOPMENT TRIALS

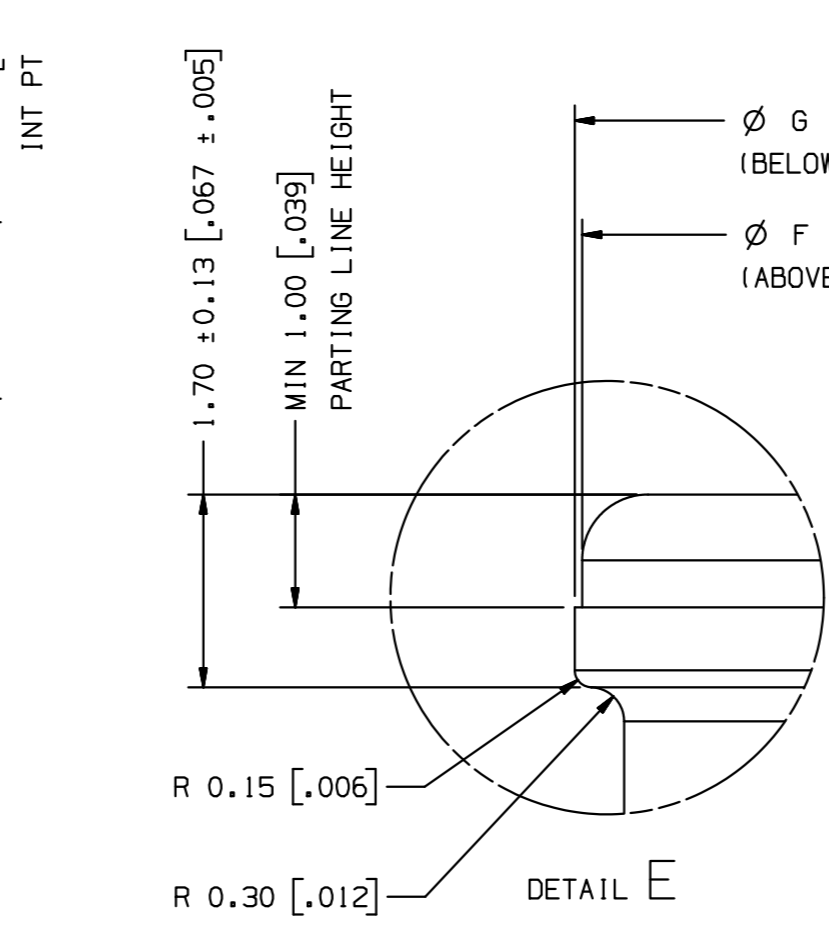

DETAIL E

PENDING VALIDATION - FINISH UNDERGOING DEVELOPMENT TRIALS

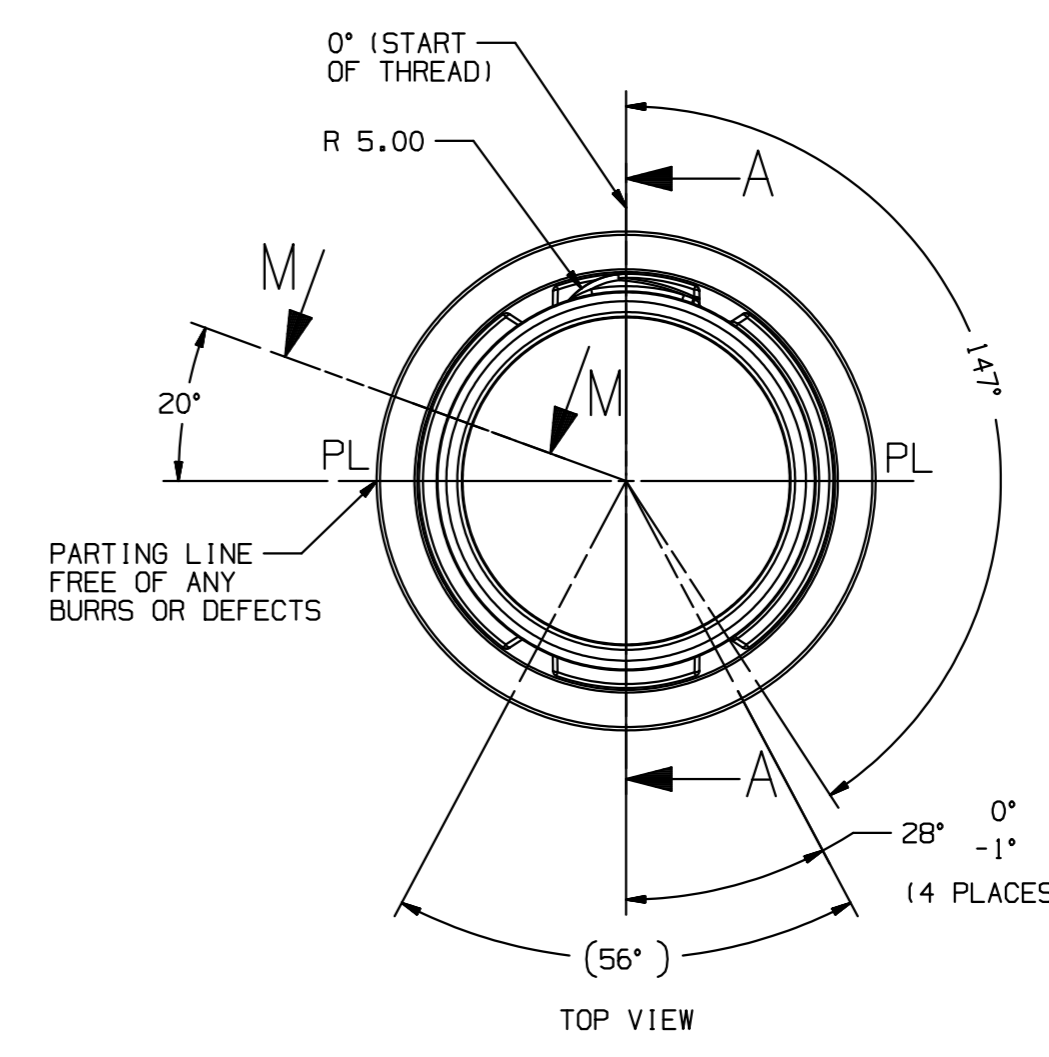

TOP VIEW

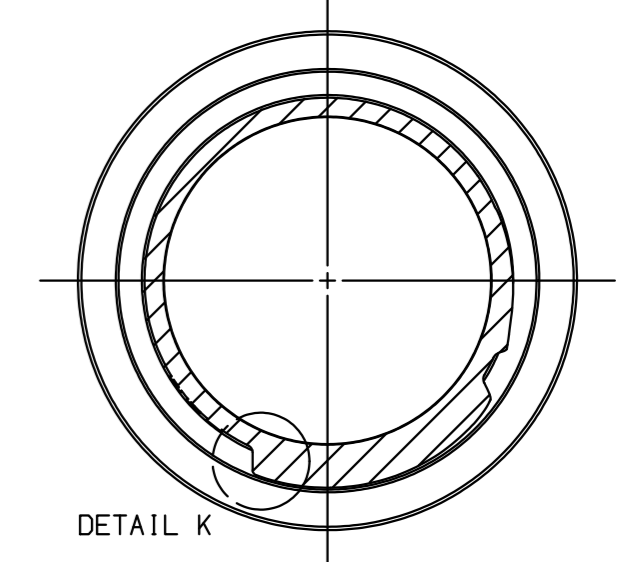

SECTION J-J

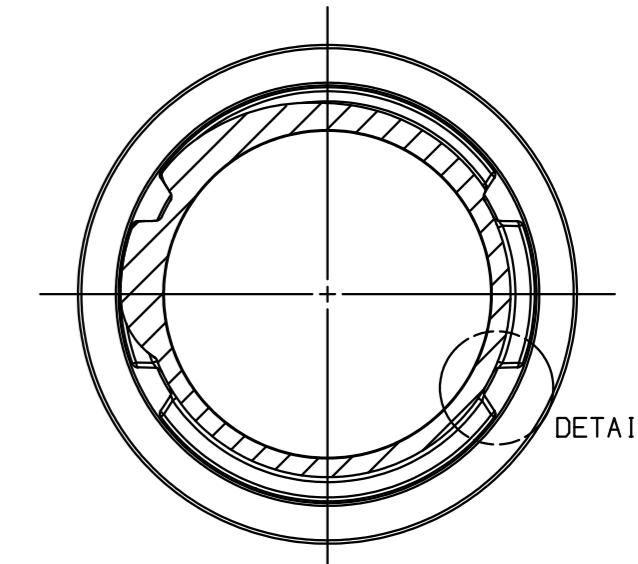

SECTION L-L

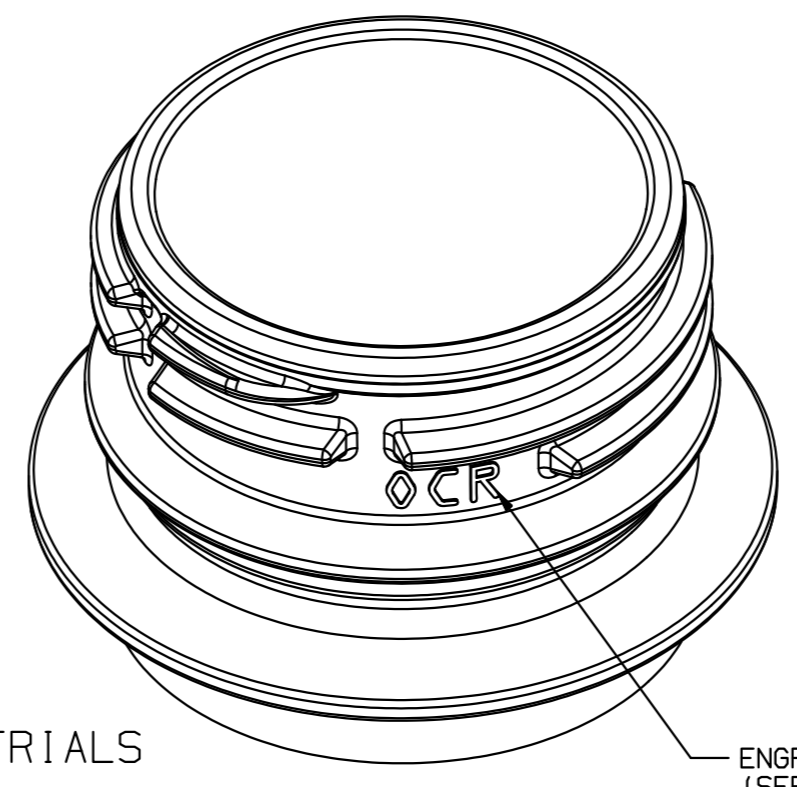

ENGRAVING AREA (SEE NOTE 6)

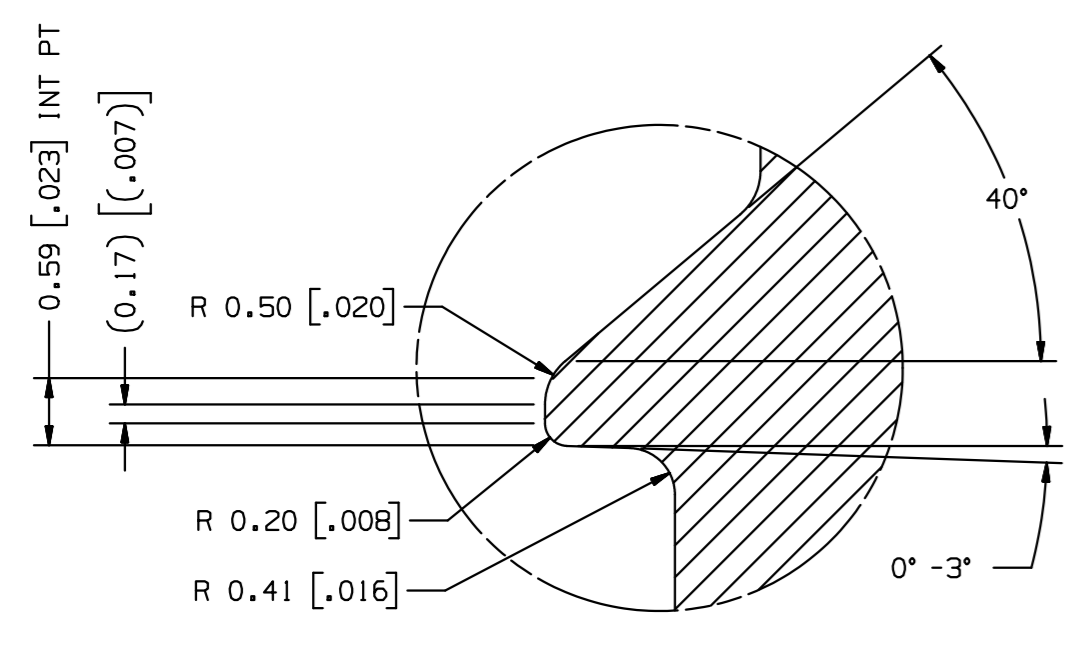

DETAIL F

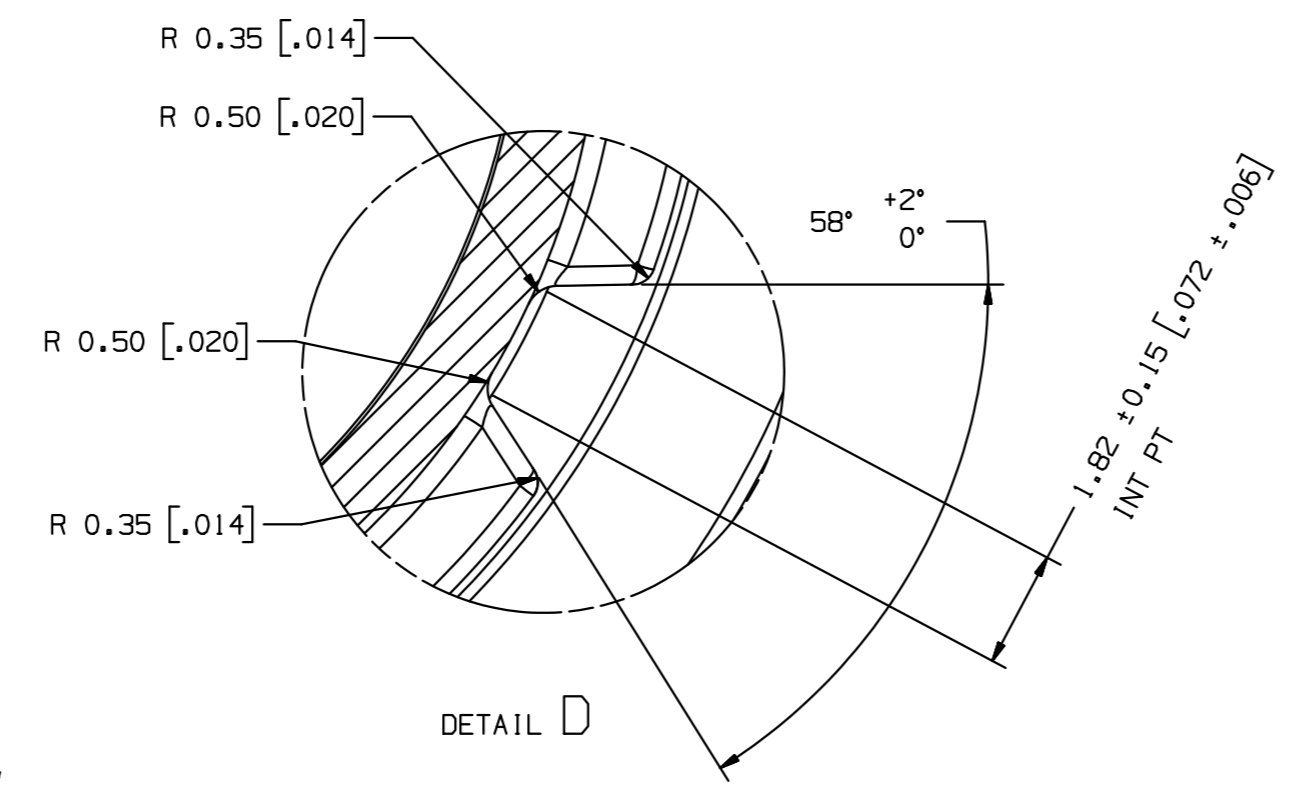

DETAIL D

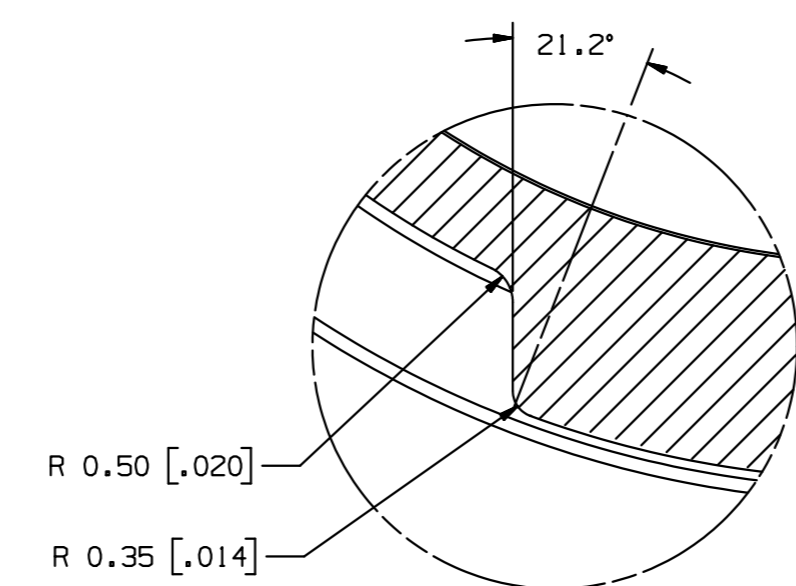

DETAIL K
END OF THREAD

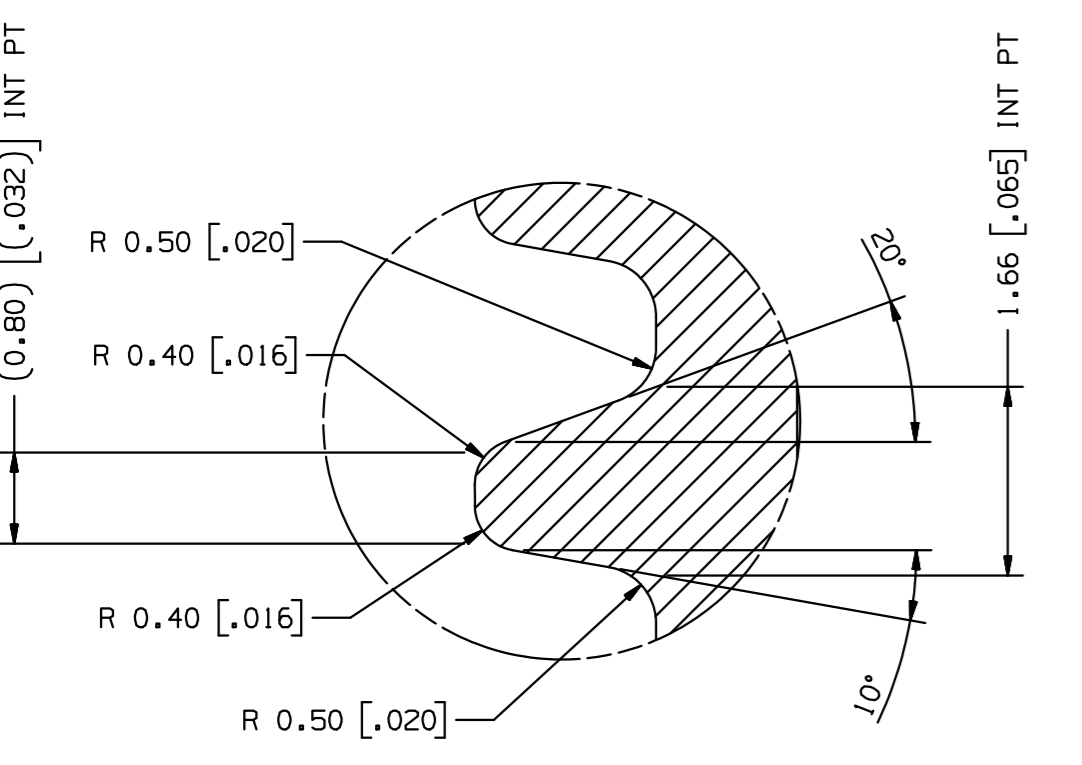

DETAIL B

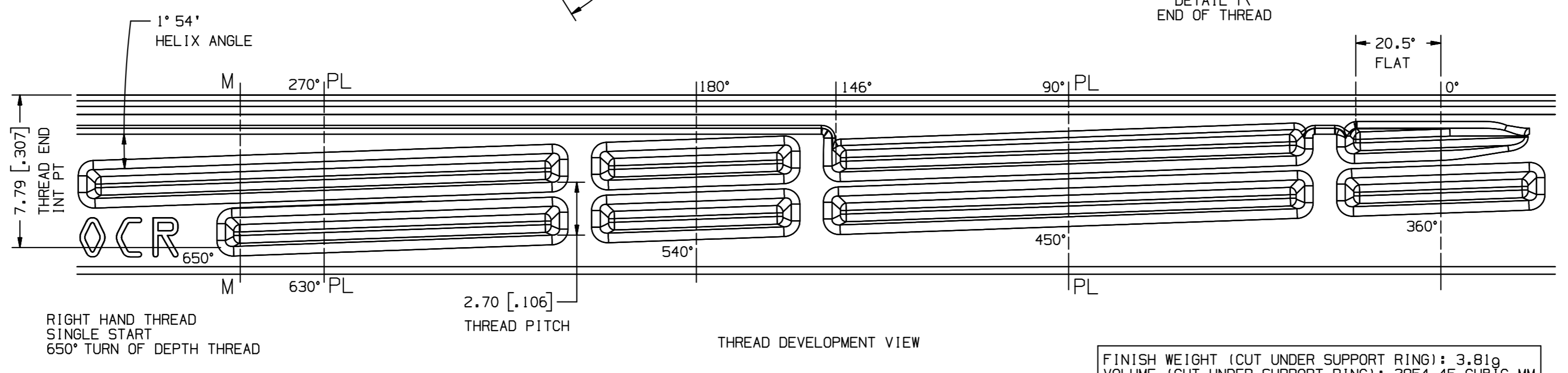

THREAD DEVELOPMENT VIEW

RIGHT HAND THREAD
SINGLE START
650° TURN OF DEPTH THREAD

FINISH WEIGHT (CUT UNDER SUPPORT RING): 3.81g
VOLUME (CUT UNDER SUPPORT RING): 2854.45 CUBIC MM

NOTES:

- THIS IS A PRESSURE TOP, SIDE AND INSIDE BORE SEAL FINISH. SURFACES OF THE FINISH, IN CONTACT WITH THE SEALING FEATURES, INCLUDING THE INSIDE DIAMETER TO THE DEPTH "V1", AND THOSE SURFACES MARKED WITH THE DESIGNATION "NOTE 1", ARE SMOOTH AND FREE OF ANY SURFACE IRREGULARITIES THAT MAY CONTRIBUTE TO THE LOSS OF PRESSURE.
- NO OVERHANG ALLOWED AT ANY POINT IN 360° BETWEEN Ø F AND Ø G. A FLUSH TO 0.13mm (.005) MAXIMUM STEP IS ALLOWABLE ON ONE SIDE ONLY.
- REFERRING TO THE SOLID MODEL (FOR TOOLING PURPOSES), THE Ø G CONTACTING THE FIRST 146° OF THREAD START IS "BLENDED" INTO THE UPPER SURFACE OF THREAD WITH A CONSTANT RADIUS OF 0.35 ± 0.10 (.014 ± .004) AT 0° AND FOR THE DURATION OF BLEND REGION.
- REQUIREMENT FOR GOOD CLOSURE APPLICATION ON FINISH
 - 0.13mm MAX (.005) OUT OF PARALLEL TOP OF FINISH WITH NECK SUPPORT LEDGE IS ALLOWED FOR COCKED NECKS AND SLANTED FINISHES.
 - AN OFFSET OF VERTICAL MISMATCH OF THREAD IS NOT TO EXCEED 0.10mm (.004) AT THE MOLD SEAM. IT IS PERMISSIBLE TO RELIEVE THREAD AT MOLD SEAM, BUT NOT TO EXCEED 0.20mm (.008) ON DIAMETER IN AN ARC OF 15°. Ø T DIMENSION IS NOT MEASURED IN THE DEPRESSED AREA.
 - FLASH NOT TO EXCEED 0.13mm (.005) PER SIDE AND NOT BE CONTINUOUS.
- THE START OF THREAD RUN-IN IS 90° ± 2° FROM PARTING LINE ON ALL FINISHES.
- PREFERRED CAVITY IDENTIFICATION ENGRAVING LOCATION AT END OF THREAD AS SHOWN, PREFERRED TO USE "OPTICAL CHARACTER RECOGNITION" (OCR) FONT TYPE.

PENDING VALIDATION - FINISH UNDERGOING DEVELOPMENT TRIALS

REFERENCE CAD SOLID MODEL FOR ALL CONSTRUCTION DETAILS.

GENERAL TOLERANCES	DIMENSIONS SHOWN ARE FINISHED PLASTIC SIZES		DESCRIPTION VOLUNTARY STANDARD 28MM PCO 1881 CSD FINISH	isbt INTERNATIONAL SOCIETY OF BEVERAGE TECHNOLOGISTS
	METRIC	(IMPERIAL)		
	MILLIMETRES	(INCHES)		
	X,X ±0,3	(.XX ±0.01)	FINISH No PCO-1881-0	DRAWING No: 3784253-17
	X,XX ±0,13	(.XXX ±0.005)		
	X° ±2°			
	X°X' ±0°15'		DWN	DATE: 2007/02/14